

AMBIUS SENSOR RANGE

SPECIFICATION SHEET

Product Code: ASECPIRS65W

Pronto Code: Q5081000

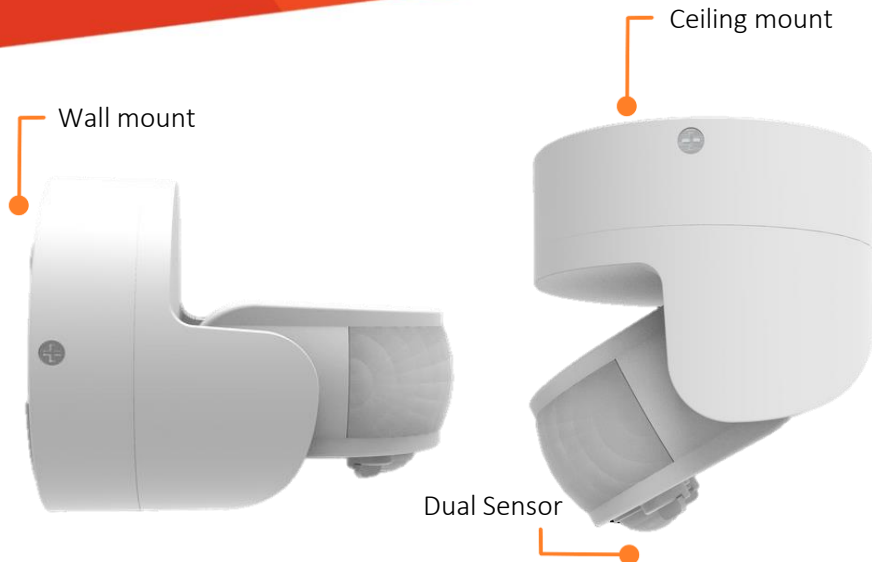

Detection Range

Detection Range maximum of 12m.



Detection Angle

Detection angle of min 180 degrees from point of sensor application.



Ingress Protection

Rated IP65, allowing for installation in a covered outdoor area.



Lux Adjustment

Ambient light: 10-2000LUX which is adjustable. Use Sun and LUX dials to choose sensor options.



Max 300W LED

Rated load:
1200W Max. (incandescent lamp)
300W Max. (energy-saving lamp).



Time On Adjustment

Time adjustment:
Min: 10sec±3sec
Max: 15min±2min

TECHNICAL SPECIFICATIONS

- 220-240V 50/60Hz

Rated Load:

- 300W LED
- 1200W Incandescent
- IP65
- Dual Sensor Angle: 180°/ 360°
- Detection Range: 12m
- Time adjustment: 10sec - 15min
- Manual Override Function
- 1-Year warranty

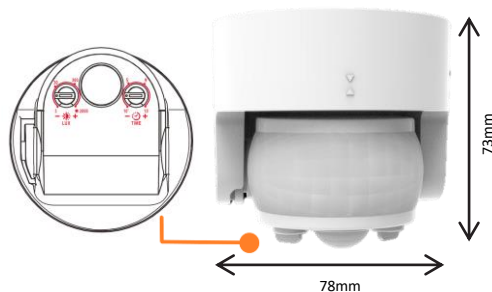

*Dimensions shown are subject to manufacturing tolerance.

INSTALLATION:

- Choose between Ceiling or Wall mount.
- Loosen the base (Figure A) with a screwdriver on the side, open the wiring cavity and feed the mains supply through the base.
- Connect power and load wire into connection-wire column.
- Note: The terminal block can be removed for easy installation.
- Fix the mounting base with supplied screws to the wall Figure B. Attach sensor to base.

Figure A:



Figure B:

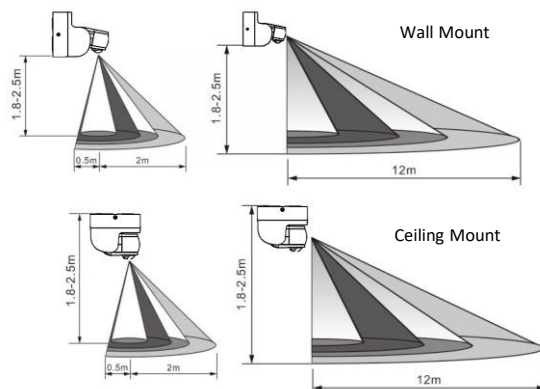
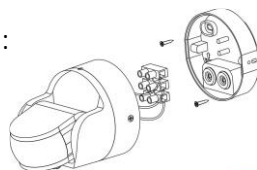

Distributed by:

CDB

GROUP

PO Box 100-707
North Shore Mail Centre
Auckland

Manufactured to Ambius Lighting's specifications in the PRC.

AMBIUS SENSOR RANGE

SPECIFICATION SHEET

Product Code: ASECPIRS65B

Pronto Code: Q5081010

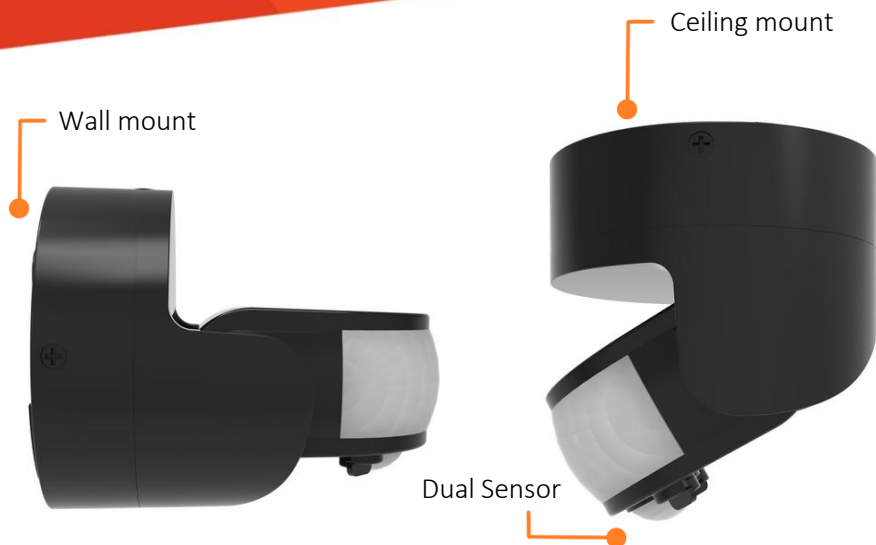

Detection Range maximum of 12m.

Detection Range



Detection angle of min 180 degrees from point of sensor application.

Detection Angle



Rated IP65, allowing for installation in a covered outdoor area.

Ingress Protection



Ambient light: 10-2000LUX which is adjustable. Use Sun and LUX dials to choose sensor options.

Lux Adjustment



Rated load:
1200W Max. (incandescent lamp)
300W Max. (energy-saving lamp).

Max 300W LED



Time adjustment:
Min: 10sec±3sec
Max: 15min±2min

Time On Adjustment

TECHNICAL SPECIFICATIONS

- 220-240V 50/60Hz
- Rated Load:
 - 300W LED
 - 1200W Incandescent
- IP65
- Dual Sensor Angle: 180°/360°
- Detection Range: 12m
- Time adjustment: 10sec - 15min
- Manual Override Function
- 1-Year warranty

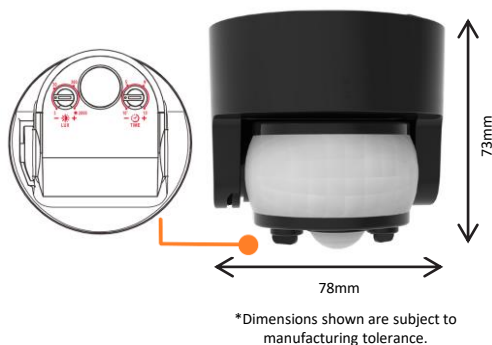

INSTALLATION:

- Choose between Ceiling or Wall mount.
- Loosen the base (Figure A) with a screwdriver on the side, open the wiring cavity and feed the mains supply through the base.
- Connect power and load wire into connection-wire column.
- Note: The terminal block can be removed for easy installation.
- Fix the mounting base with supplied screws to the wall Figure B. Attach sensor to base.

Figure A:



Figure B:

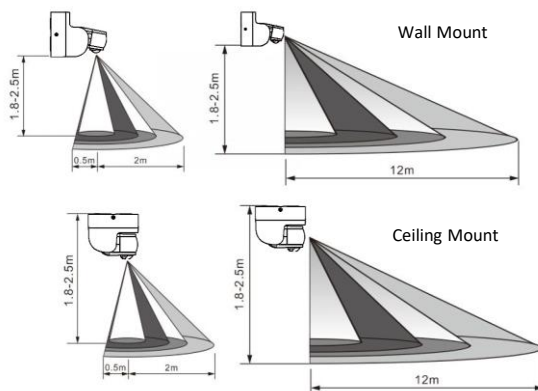
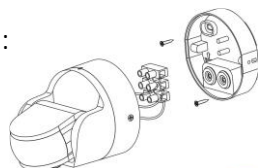

Distributed by:

CDB

GROUP

PO Box 100-707
North Shore Mail Centre
Auckland

Manufactured to Ambius Lighting's specifications in the PRC.